

ANNEXURE- "B": IJCNLP-AAAL 2025 AV requirements

(c) 2025 Underline Science, Inc.					
Plenary room	Quantity	Comments	Breakout Room	Quantity	
Laptop	3		Laptop	1	
Camera	2		Camera	1	Can be a webcam
HDMI to SDI converter (Bidirectional)	4	For camera	HDMI Splitter	1	
HDMI Splitter	2	For projectors and confidence monitor	Audio Mixer 8 channel	1	
Video Mixer / switcher	1		Audio Capture card	1	
Audio Mixer 12-16 channel	1		Wireless HH mic	2	
Audio Capture card	1		Podium Goosneck microphone on lectern	1	
Wireless HH mic	4	For QA, session chair etc.	Microphone stands	2	
Podium Goosneck microphone on lectern	1	Can also be lavalier, but we recommend gooseneck	Speakers	2	
Microphone stands	2	For QA in aisle	Projector	1	
Speakers	4-6	Depends on room size	Projector Screen	1	
Projector	1-2	Depends on room size	Clicker	1	
Projector Screen	1-2	Depends on room size	Confidence monitor	1	Nice to have
Clicker (Perfect Cue)	1				
Confidence Monitor	1-2				
Pipe & Drape	1	Nice to have			
Lights set - speaker spotlight	4-8	Nice to have			
Lights set - stage dress lights	4-12	Nice to have			

Reference: Sample of Equipment models

Plenary room	Model - Offer same or similar	Breakout Rooms	Model - Offer same or similar
Laptop	Lenovo Legion or similar	Laptop	Lenovo ThinkBook 15 G2 i7 2.8GHz or similar
Camera	Full HD camera (1080p or higher)	Camera	Obsbot Tiny 2, Logitech HD Pro c920
HDMI to SDI converter (Bidirectional)	Blackmagic, AJA, Decimator MD-HX	USB C Dongle	Lionwei or similar
HDMI Splitter	Gefen 1x4 HDMI DA	Audio Mixer 8 channel	Yamaha MG10XU, Behringer XENYX 1202SFX
Video Mixer / switcher	Atem mini pro, Roland V80 pro	Audio Capture card	Behringer U-phoria UMC22 / Focusrite Scarlett
Audio Mixer	Yamaha MG 12XU / Allen & Heath ZED60-14FX	Wireless HH mic	Shure ULX-D / SLX-D / QTX-D
Audio Capture card	Behringer U-phoria UMC22 / Focusrite Scarlett	Podium Goosneck microphone on lectern	Shure MX418 / Shure MX412D/S
Wireless HH mic	Shure ULX-D / SLX-D / QTX-D	Microphone stands	Any (5/8"-27 thread (imperial))
Podium Goosneck microphone on lectern	Shure MX418 / Shure MX412D/S	Speakers	QSC K12 400 watt / QSC CP12 or similar
Wireless Lav (optional)	Shure WL185M	Projector	4000 Lumen HD LCD Projector
Mic Stands	Any (5/8"-27 thread (imperial))	Projector Screen	8' tripod screen (depends on the room and requirements)
Speakers	QSC K12 400 watt / QSC CP12 or similar	Clicker	Logitech Spotlight clicker / Logitech R400
Projector	7000 Lumen HD LCD Projector	Confidence monitor	Samsun/LG 50 - 55 inch / AsusZen screen
Projector Screen	16' fastfold F/R with skirt (depends on the room and requirements)		
Clicker	Perfect Cue Dsan		
Confidence Monitor	Samsun/LG 50 - 55 inch		
Pipe & Drape - Stage Dressing	13' high black drape		
Lights set - speaker spotlight	ETC 26 degree (ProLights Eclipse FS RGBL Spot LED) or similar		
Lights set - stage dress lights	Chroma-Q ColorForce 12 LED Batten Series 1 or similar		

PLENARY ROOM

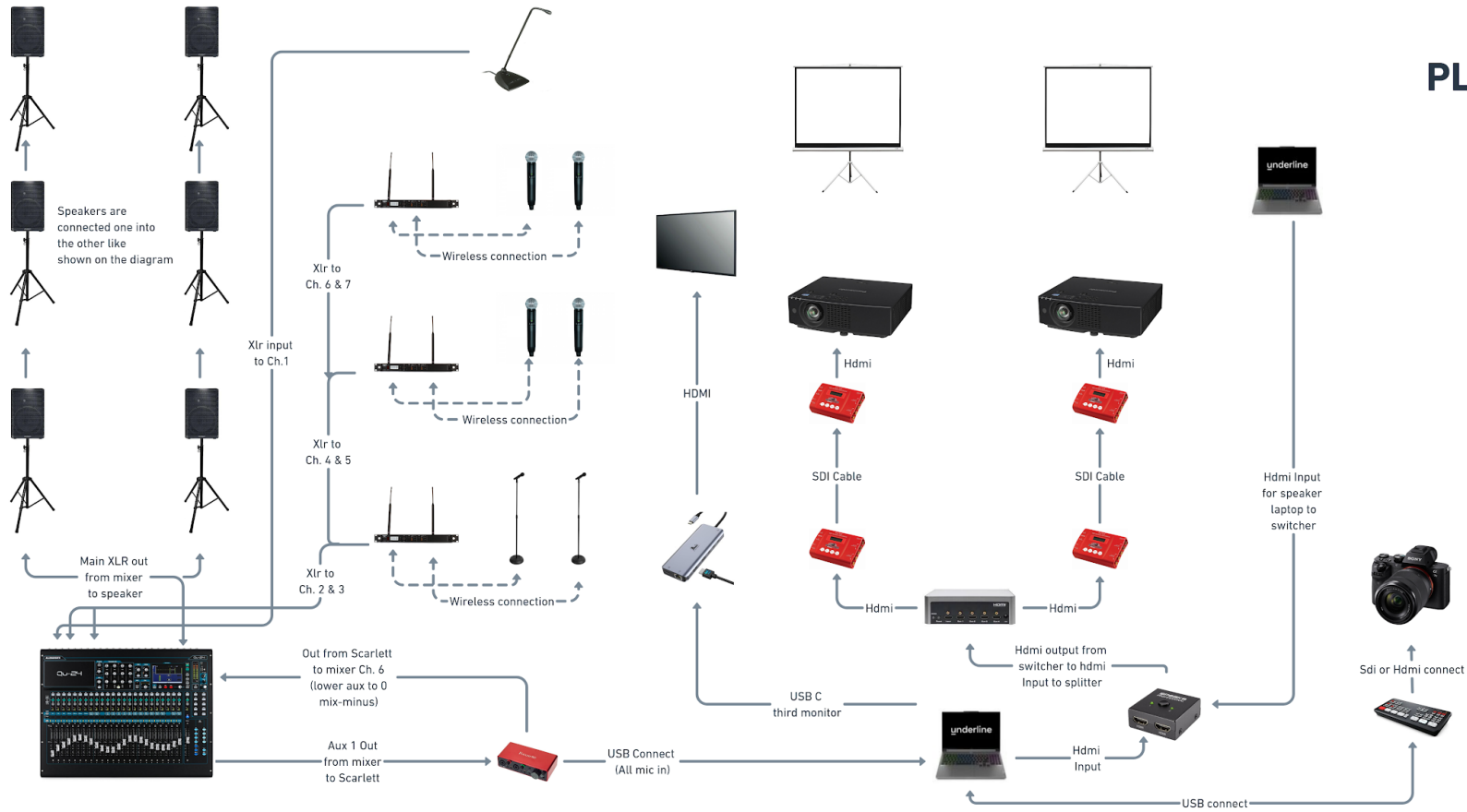

BREAKOUT ROOM

